



AIR CONDITIONING



REFRIGERATION



HEATING



# mini tank

## CONDENSATE REMOVAL PUMP



The new and improved Mini Tank pump can be wall mounted, floor mounted, in-pan or suspended on M8 / M10 rod. Using piston technology this is a compact, powerful and multi functional tank pump.



35L/h max. flow



15m max. rec. head (flow rate 10L/h)

### KEY FEATURES

- Four ways to install
- Compact & discreet
- Can be located in drain pan
- Easy maintenance

### SUITABILITY

- Up to 46kW / 157,000Btu/h
- Ducted units; Floor standing & chassis units; Cassette units

✓ **Perfect for...** Installation versatility



0.57 kg

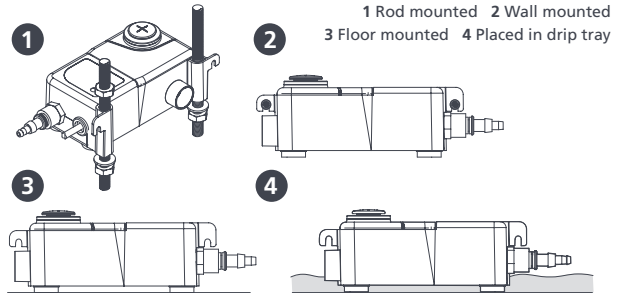
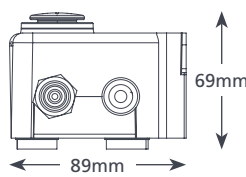
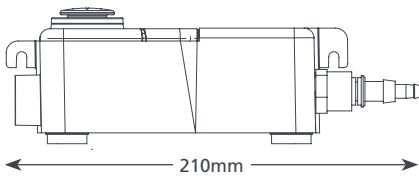

### MINI TANK SPECIFICATIONS

|                    |                                       |
|--------------------|---------------------------------------|
| Max. flow          | 35L/h @ 0 head                        |
| Max. rec. head     | 15m                                   |
| Tank capacity      | 0.24L                                 |
| Sound level@1m     | 35dB(A)                               |
| Power supply       | 230 VAC, 0.1A, 16W, 50/60Hz           |
| Rated              | Non continuous                        |
| Class              | II appliance <input type="checkbox"/> |
| Max. unit output   | 46kW / 157,000Btu/h                   |
| Max. water temp    | 40°C / 104°F                          |
| Inlets             | x2 22mm, 12mm & 27mm                  |
| Outlets            | 6mm & 10mm                            |
| IP Protection      | IP65                                  |
| Safety switch      | 3.0A Normally closed                  |
| Thermal protection | ✓                                     |
| Fully potted       | ✓                                     |
| Self priming       | n/a                                   |

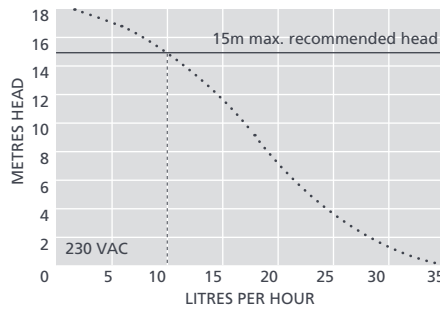

### SUGGESTED XTRA ACCESSORIES

| Description                   | Part No. |
|-------------------------------|----------|
| Tank pump connector 16mm-21mm | FP2011   |
| Tube To Soil Stack Adaptor    | FP2038   |
| Vinyl Tube Braided 1/4" (6mm) | AX5110   |



For more installation accessories take a look at our Aspen Xtra range

### MINI TANK OPTIONS

Mini Tank FP1056/2

### IN THE BOX

Mini Tank pump (including hard wired 1.5m power cable) • x2 Rubber adaptors (21.5mm & 31mm) • Anti siphon device • Fixing kit • Install manual

Download manual at [aspenspumps.com](http://aspenspumps.com)

View install video at [aspenspumps.com](http://aspenspumps.com)

Information correct at time of going to press.



[aspenspumps.com](http://aspenspumps.com)

+44 (0)1323 848842

[sales@aspenspumps.com](mailto:sales@aspenspumps.com)

reliable | silent | simple