

COMPRESSOR

| | |
|---------------------------------|-----------------|
| Displacement (cm ³) | 5.67 |
| Diameter (mm) | 21.99 |
| Stroke (mm) | 14.9 |
| Net Weight (Kg) | 9.5 |
| Oil type | ISO VG 22 ESTER |
| Oil charge (cm ³) | 300 |

MOTOR

| | |
|------------------------------|-----------|
| Approximate Power (CV) | 1/5 |
| Voltage/Frequency (V/Hz) | 220V 50Hz |
| Voltage range (V) | 198-264 |
| Code | 60.100 |
| Type | RSIR |
| Phase number | 1 PH |
| Locked rotor current (A) | 11.6 |
| Main W. resist. at 25°C (Ω) | 12.34 |
| Start W. resist. at 25°C (Ω) | 37.62 |

APPLICATION

| | |
|-------------------------|-------------------------|
| Application | High/Mid. back pressure |
| Refrigerant | R134a |
| Evaporating (°C) | -25 to 10 |
| Expansion | Capillar |
| Comp. cooling | Fan cooled |
| Max. ambient temp. (°C) | 43 |

| NOMINAL PERFORMANCE | CYCLE C | CYCLE D |
|---------------------------|---------|---------|
| Cooling capacity (kcal/h) | 376 | 450 |
| Input power (W) | 240 | 250 |
| EER (kcal/Wh) | 1.56 | 1.80 |
| COP (W/W) | 1.81 | 2.09 |
| Current (A) | 1.45 | 1.50 |

TEST CONDITIONS

| | | |
|-----------------------------|-----------|-----------|
| Evaporating temp. (°C) | 5.0 | 7.2 |
| Condensing temp. (°C) | 55.0 | 55.0 |
| Liq.t. entering expan. (°C) | 55.0 | 46.0 |
| Ambient t. and return (°C) | 32.0 | 35.0 |
| Tens/Freq (V/Hz) | 220V 50Hz | 220V 50Hz |

ELECTRICAL COMPONENTS

| | | | |
|------------------------------|-------------|--------------|--------------|
| Relay | 2014 118. | | |
| Pick-Up (A) | 3.75 | | |
| Drop-Out (A) | 3.20 | | |
| Protector | MRP61AMJ | T0073 | AE22FHY |
| Current (A) | 6.9 | 6.2 | 6.2 |
| Time check (seg) | 7.5-14 | 7.5-14 | 7.5-14 |
| Disc temp. (Open/Close) (°C) | 90.0 / 57.0 | 110.0 / 62.0 | 105.0 / 62.0 |

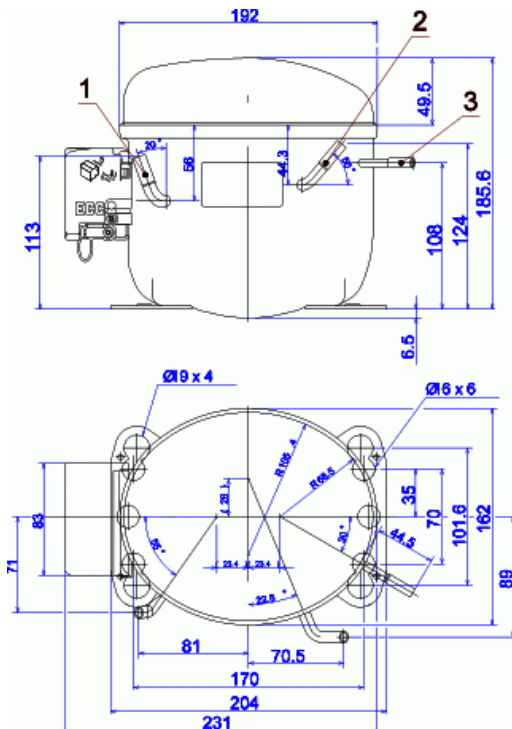
DIMENSIONS AND ELECTRICAL DIAGRAM

| DESIGNATION | INTERNAL DIAM. (MM) |
|-------------------|---------------------|
| 1 Suction/Service | 6.5 |
| 2 Service/Suction | 6.5 |
| 3 Discharge | 4.9 |

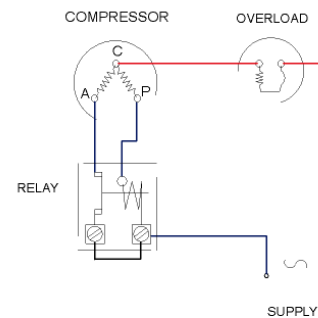
RSIR

TEST CONDITIONS

| | |
|------------------------|----------------|
| Voltage/frequency | 220V 50Hz |
| Ambient t. and return | 35 °C |
| Liq.t. entering expan. | Subcooling 9 K |

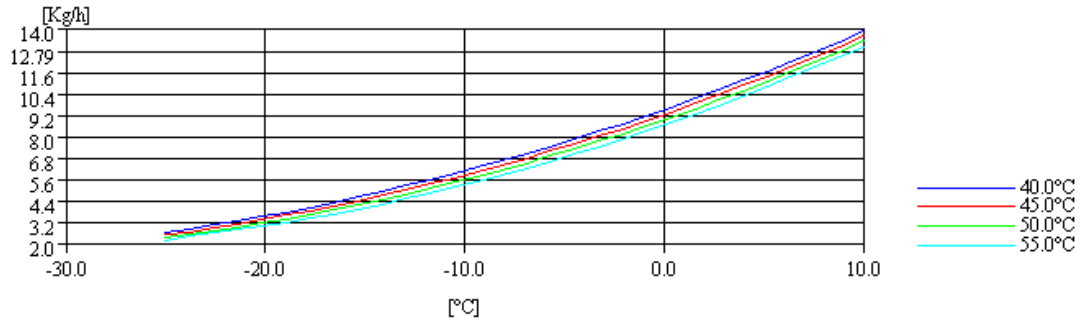
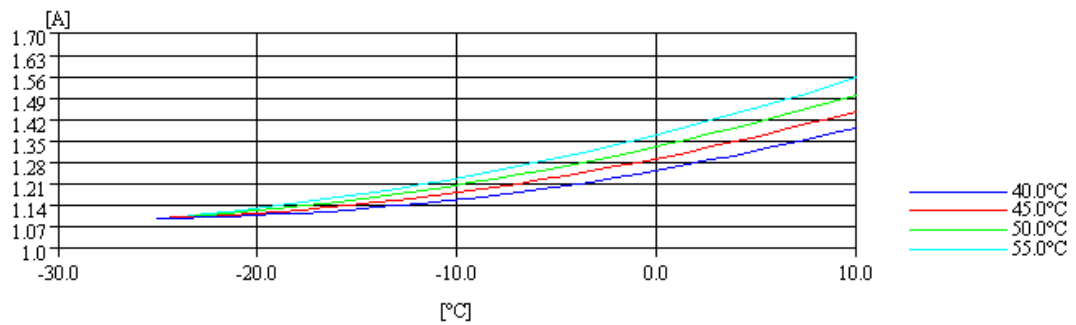
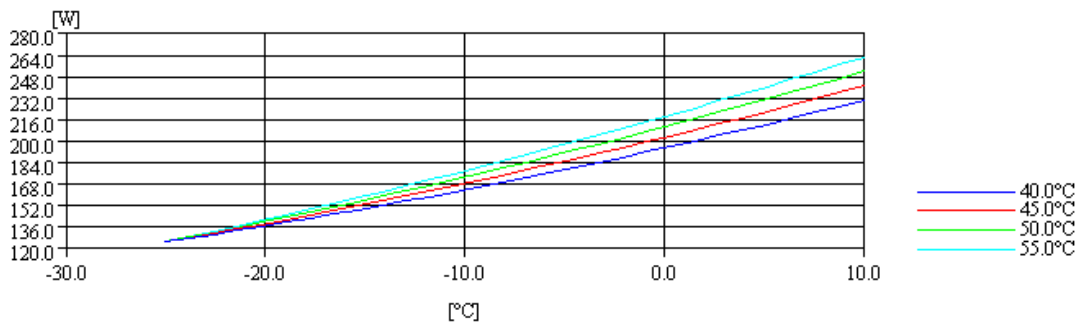
MASS FLOW

INTENSITY

CONSUMPTION

COOLING CAPACITY
