

# GENERAL DATA

## Z Series

### DC inverter

Series				Z																	
Model				ZS7798D1								ZS1216D1									
Scroll Profile				Algebraic								Algebraic									
Rated Output				770								1,250									
Displacement				9.8								15.9									
Power supply				DC inverter								DC inverter									
Oil				POE								POE									
Oil Charge				550								650									
Weight				10.8								11.1									
Overload Protection				OHR(Overheat relay)								OHR(Overheat relay)									
Motor Type				DC Inverter								DC Inverter									
Test Condition				EN12900 MT		ARI540 MT		EN12900 LT		ARI540 LT		EN12900 MT		ARI540 MT		EN12900 LT		ARI540 LT			
				N(Hz)		25		100		25		100		25		100		25		100	
Performance	R404A	Cooling Capacity	W	510	2,030	535	2,135	195	780	220	890	825	3,295	865	3,465	315	1,265	360	1,440		
			BTU/h	1,740	6,927	1,826	7,286	665	2,662	751	3,037	2,815	11,244	2,952	11,824	1,075	4,317	1,229	4,914		
	R449A	Cooling Capacity	W	490	1,960	530	2,115	180	710	210	820	795	3,180	860	3,435	290	1,150	335	1,330		
			BTU/h	1,672	6,689	1,809	7,217	614	2,423	717	2,798	2,713	10,852	2,935	11,722	990	3,924	1,143	4,539		
R448A	Cooling Capacity	W	490	1,960	530	2,115	180	710	210	820	795	3,180	860	3,435	290	1,150	335	1,330			
		BTU/h	1,672	6,689	1,809	7,217	614	2,423	717	2,798	2,713	10,852	2,935	11,722	990	3,924	1,143	4,539			
Certificate				CE								CE									

Series				Z																	
Model				ZS1520D1								※ZS098XJ1									
Scroll Profile				Algebraic								Algebraic									
Rated Output				1,500								770									
Displacement				20.1								9.8									
Power supply				DC inverter								DC inverter									
Oil				POE								POE									
Oil Charge				650								550									
Weight				10.9								10.8									
Overload Protection				OHR(Overheat relay)								OH thermista(Temperature detection) + Inverter control									
Motor Type				DC Inverter								DC Inverter									
Test Condition				EN12900 MT		ARI540 MT		EN12900 LT		ARI540 LT		EN12900 MT		ARI540 MT		EN12900 LT		ARI540 LT			
				N(Hz)		25		91.7		25		91.7		25		100		25		100	
Performance	R404A	Cooling Capacity	W	1,040	3,820	1,095	4,015	400	1,465	455	1,670	-	-	-	-	-	-	-	-		
			BTU/h	3,549	13,036	3,737	13,701	1,365	4,999	1,553	5,699	-	-	-	-	-	-	-	-		
	R449A	Cooling Capacity	W	1,005	3,685	1,085	3,980	365	1,335	420	1,545	-	-	-	-	-	-	-	-		
			BTU/h	3,430	12,575	3,703	13,582	1,246	4,556	1,433	5,272	-	-	-	-	-	-	-	-		
	R448A	Cooling Capacity	W	1,005	3,685	1,085	3,980	365	1,335	420	1,545	-	-	-	-	-	-	-	-		
			BTU/h	3,430	12,575	3,703	13,582	1,246	4,556	1,433	5,272	-	-	-	-	-	-	-	-		
	R1270	Cooling Capacity	W	-	-	-	-	-	-	-	-	530	2,115	570	2,260	220	885	250	1,000		
			BTU/h	-	-	-	-	-	-	-	-	1,809	7,217	1,945	7,712	751	3,020	853	3,413		
R290	Cooling Capacity	W	-	-	-	-	-	-	-	-	440	1,750	470	1,870	180	715	205	815			
		BTU/h	-	-	-	-	-	-	-	-	1,502	5,972	1,604	6,381	614	2,440	700	2,781			
Certificate				CE								CE									

### Test Condition

	Te(°C)	T(°C)	SC(deg)	Ts(°C)
EN12900 MT	-10.0	45.0	0	20.0
EN12900 LT	-35.0	40.0	0	20.0
ARI540 MT	-6.7	48.9	0	18.3
ARI540 LT	-31.7	40.6	0	18.3

※ Under development

Note:

Algebraic: Type of scroll wrap improved performance at low temperature condition.

Series				Z															
Model				※ZS159XJ1								※ZS201XJ1							
<b>Scroll Profile</b>				Algebraic								Algebraic							
Rated Output		W		1,250								1,500							
Displacement		cm <sup>3</sup> /rev.		15.9								20.1							
Power supply		Phase	φ	DC inverter								DC inverter							
		Voltage	V																
		Frequency	Hz																
Oil				25-100								25-91.7							
Oil Charge		cm <sup>3</sup>		POE								POE							
Weight		kg		650								650							
		lbs		11.1								10.9							
Overload Protection				OH thermista(Temperature detection) + Inverter control								OH thermista(Temperature detection) + Inverter control							
Motor Type				DC Inverter								DC Inverter							
Test Condition				EN12900 MT				ARI540 MT				EN12900 LT				ARI540 LT			
		N(Hz)		25	100	25	100	25	100	25	100	25	91.7	25	91.7	25	91.7	25	91.7
Performance	R1270	Cooling Capacity	W	860	3,430	920	3,670	360	1,435	405	1,625	1,085	3,980	1,160	4,255	450	1,660	515	1,885
			BTU/h	2,935	11,705	3,140	12,524	1,229	4,897	1,382	5,545	3,703	13,582	3,959	14,520	1,536	5,665	1,757	6,433
Performance	R290	Cooling Capacity	W	710	2,840	760	3,035	290	1,165	330	1,320	890	3,295	960	3,520	365	1,350	415	1,535
			BTU/h	2,423	9,692	2,594	10,357	990	3,976	1,126	4,505	3,037	11,244	3,276	12,012	1,246	4,607	1,416	5,238
<b>Certificate</b>				CE								CE							

# SPECIFICATION

## Z Series



## DIMENSIONS

	mm	
	A	B
<b>ZS4084</b>	311	357
<b>ZS6013</b>	316	362
<b>ZS1120</b>	321	367
<b>ZS7798/ZS098</b>	302	348
<b>ZS1216/ZS159</b>	307	353
<b>ZS1520/ZS201</b>	302	348
<b>ZD125XC1</b>	307	353
<b>ZD201XC1</b>	302	348

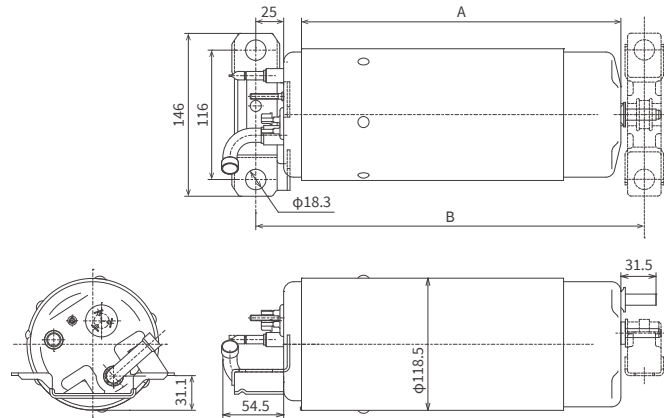

## WORKING RANGE

### R404A

ZS4084S1/ZS4084P1/ZS6013S1/ZS6013P1/ZS6013X1/ZS7516S1/ZS7516X1

### R449A

ZS4084S1/ZS6013S1/ZS6013X1/ZS7516S1/ZS7516X1

### R448A

ZS6013X1/ZS7516X1

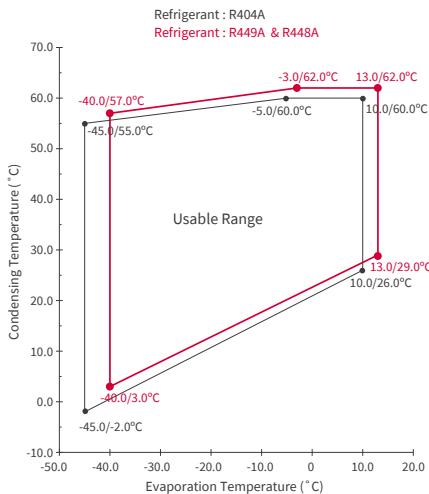

### R1270

ZS7516S3

### R290

ZS6013X3/ZS7516S3/ZS7516X3

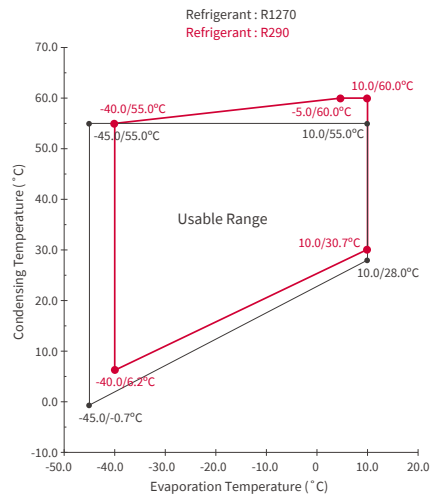

WORKING RANGE

R404A

ZS1120S1/ZS1120S2/ZS1120X1

R449A R448A

ZS1120S1/ZS1120X1 ZS1120X1

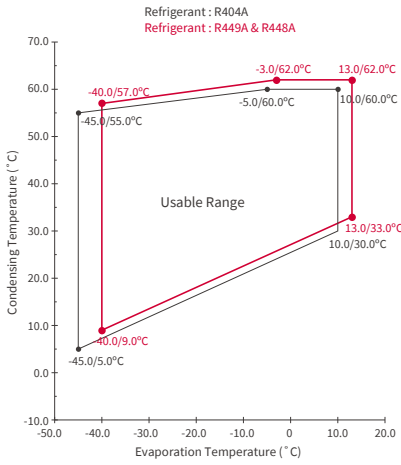

R1270

ZS1120S3

R290

ZS1120S3/ZS1120X3

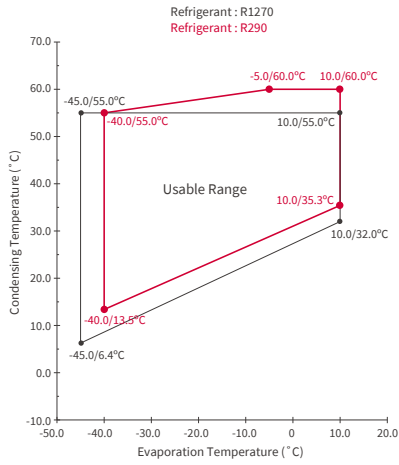

R404A

ZS7798D1/ZS1216D1/ZS1520D1

R449A, R448A

ZS7798D1/ZS1216D1/ZS1520D1

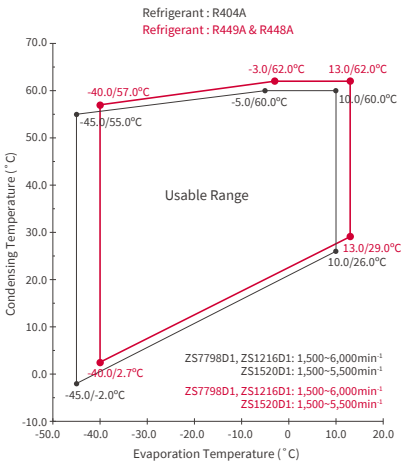

R1270

ZS098XJ1/ZS159XJ1/ZS201XJ1

R290

ZS098XJ1/ZS159XJ1/ZS201XJ1

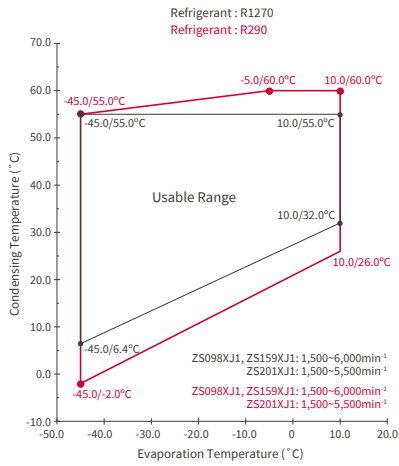

R410A

ZD125XC1

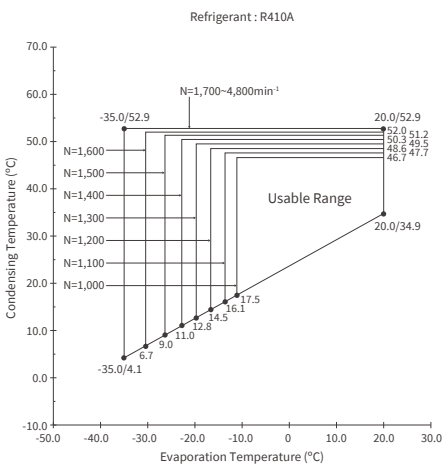

R410A

ZD201XC

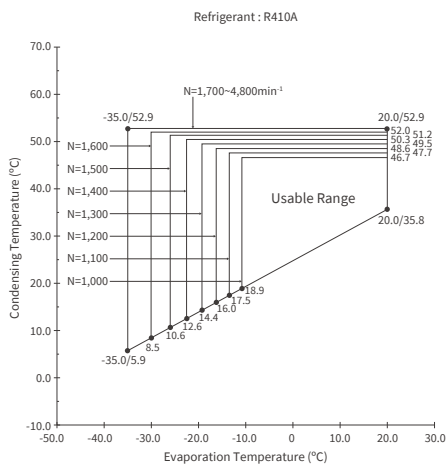

# SPECIFICATION

## DS Series



## DIMENSIONS

	mm	
	A	B
<b>DS1836S1</b>	391	
<b>DS1529</b>		220
<b>DS1834</b>	386	
<b>DS2244V1</b>	441	270

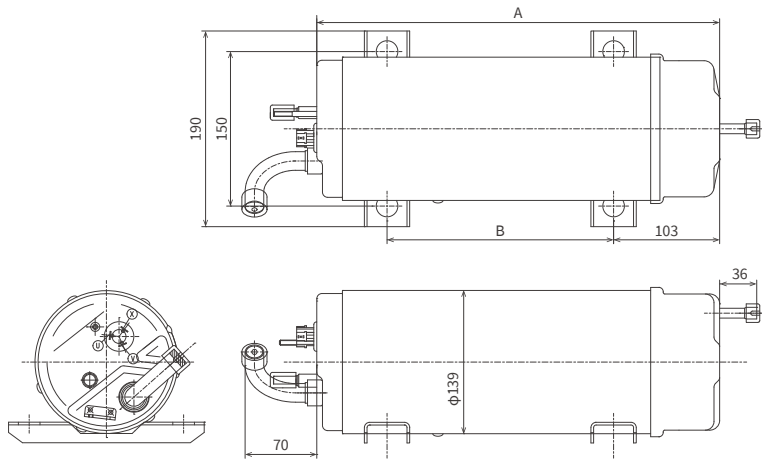

## WORKING RANGE

### R404A

DS1836S1/DS1529S1/DS1529X1/DS1529V1/DS1834X1/DS1834V1/DS2244V1

### R449A

DS1836S1/DS1529S1/DS1529X1/DS1834X1

### R448A

DS1529X1/DS1834X1

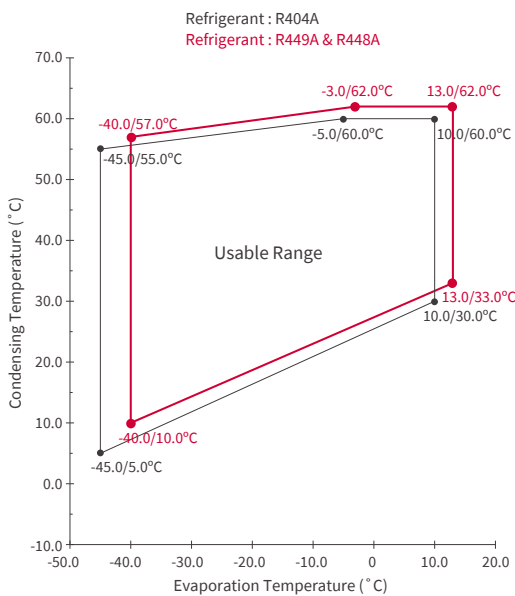

### R1270

DS1836S1/DS1529S1

