

### KSA Series AC Output

Output: AC Current Range: 2A

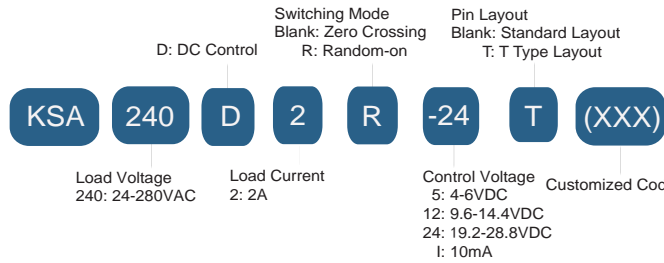

Standard Layout

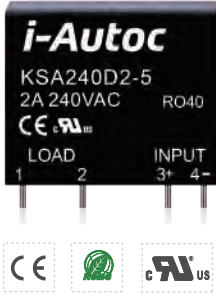
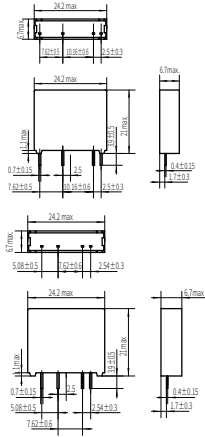

T Type Layout

### KSB Series AC Output

Output: AC Current Range: 2A - 3A

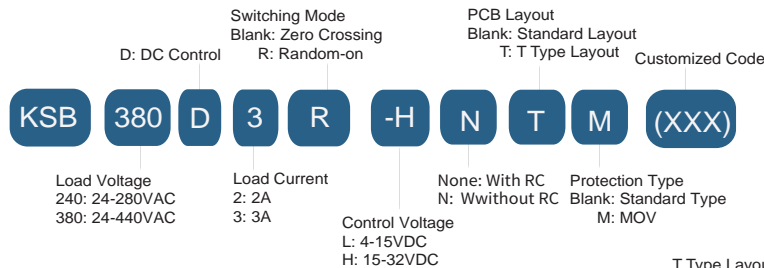

Standard Layout

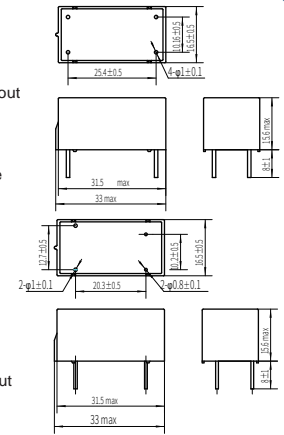

T Type Layout

Note N or M has no UL.

### KSC Series AC Output

Output: AC Current Range: 1A - 2A

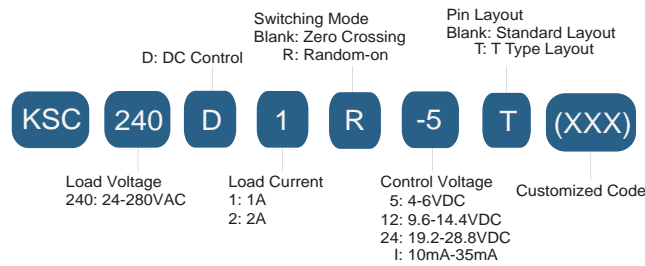
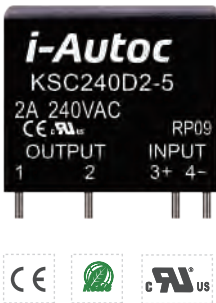

Standard Layout

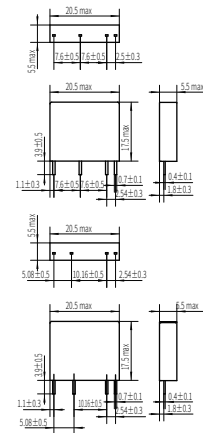

T Type Layout

### KSD Series AC Output

Output: AC Current Range: 5A

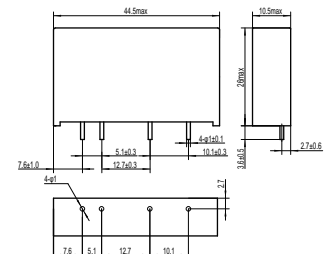
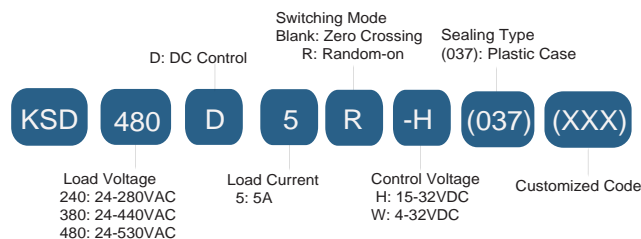
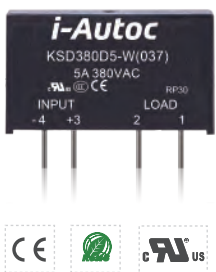

PCB Mount

**KSG Series AC Output**

Output: AC Current Range: 2A-3A

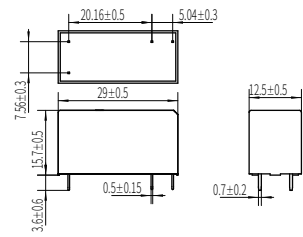
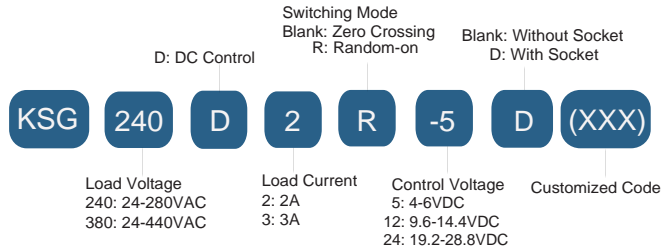

**KSH Series AC Output**

Output: AC Current Range: 25A

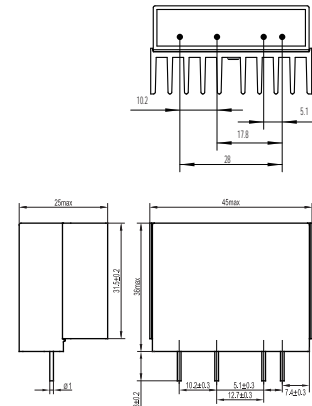
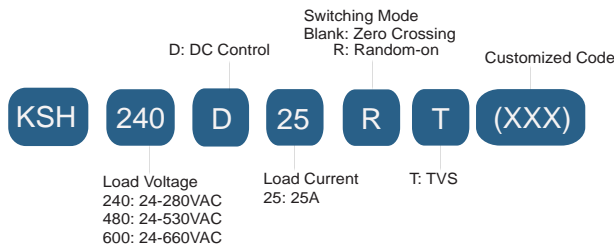

**KSG3R Series AC Output**

Output: AC Current Range: 2A-3A

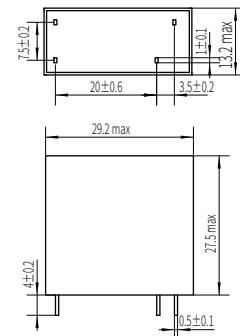
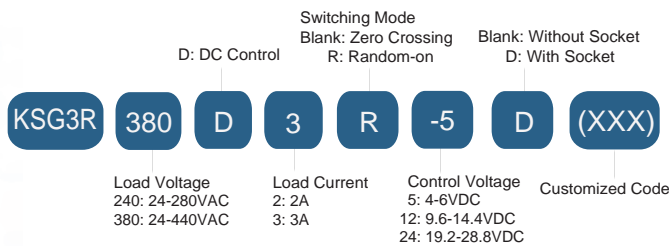

**KSFA Series AC Output**

Output: AC Current Range: 2A-3A

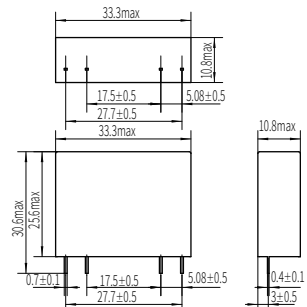
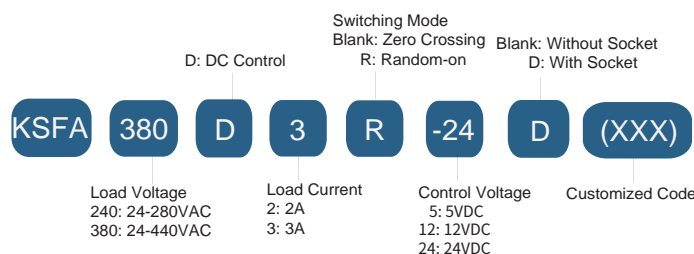

### KSF Series DC Output

Output: DC Current Range: 5A

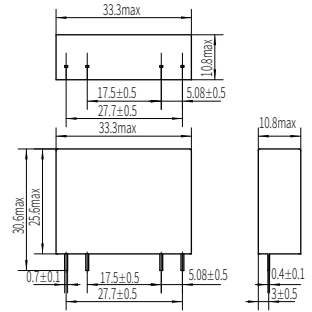
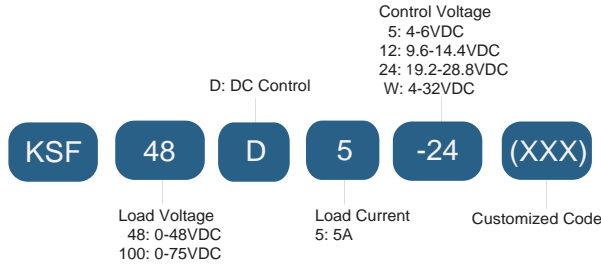

### KSCD Series DC Output

Output: DC Current Range: 1A - 4A

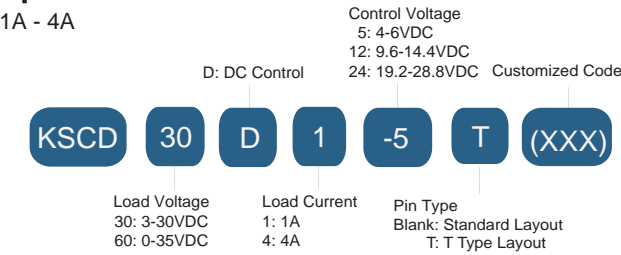

Models in detail

	1A	4A
5VDC	KSCD30D1-5(T)	KSCD60D4-5(T)
12VDC	KSCD30D1-12(T)	KSCD60D4-12(T)
24VDC	KSCD30D1-24(T)	KSCD60D4-24(T)

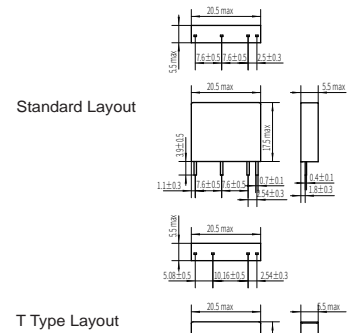

### KSGD Series DC Output

Output: DC Current Range: 2A - 5A

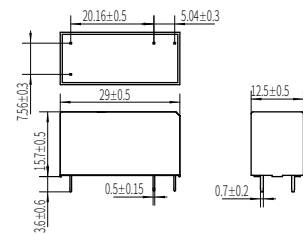
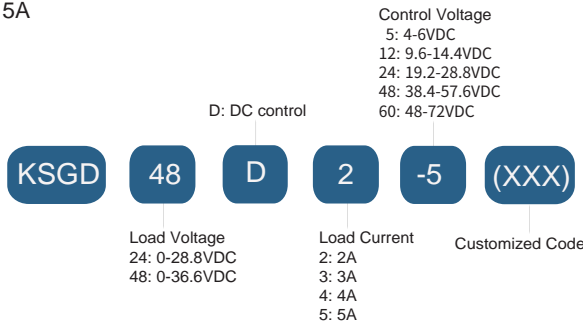

### KG3RD Series DC Output

Output: DC Current Range: 2A

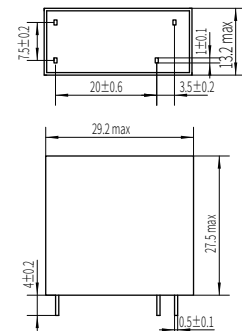
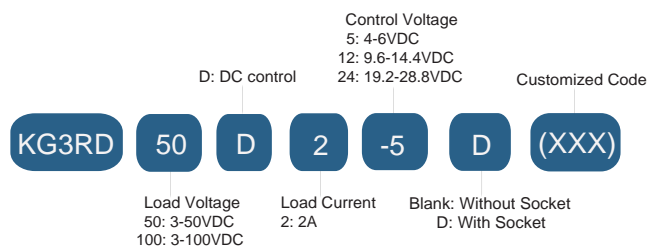

## PCB Mount

### KSLE Series DC Output

Output: DC Current Range: 3A-20A



D: DC Control

Control Voltage  
L: 3-10VDC  
H: 10-28VDC

KSLE 60 D 20 -L (XXX)

Load Voltage      Load Current      Customized Code

60: 0-50VDC	3: 3A	
100: 0-75VDC	5: 5A	
200: 0-125VDC	10: 10A	
400: 0-300VDC	20: 20A	

Models in detail

	3A	5A	10A	20A
L	KSLE60D3-L	KSLE200D5-L	KSLE60D10-L	KSLE60D20-L
H	KSLE60D3-H	KSLE200D5-H	KSLE60D10-H	KSLE60D20-H

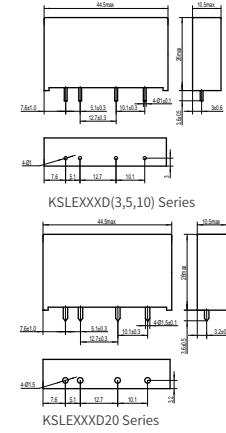

## Panel Mount

### KSIM Series Mini Single Phase AC Output

Output: AC Current Range: 10A-25A



Control Voltage  
D: 4-32VDC

Switching Mode  
Blank: Zero Crossing  
R: Random-on

Protection Type  
Blank: Standard Type  
M: MOV  
T: TVS

KSIM 380 D 25 R -L M (XXX)

Load Voltage      Load Current      L: LED      Customized Code

240: 24-280VAC	10: 10A	
380: 24-440VAC	16: 16A	
	25: 25A	

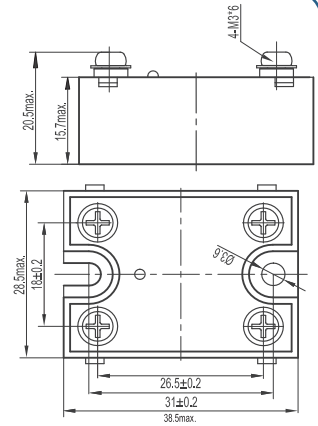

### KSIM (045) Series Mini Single Phase AC Output

Output: AC Current Range: 10A-25A



Control Voltage  
D: 4-32VDC

Switching Mode  
Blank: Zero Crossing  
R: Random-on

Quick-Connect Terminal

Customized Code

KSIM 240 D 25 R -L (045) M (XXX)

Load Voltage      Load Current      L: LED      Protection Type

240: 24-280VAC	10: 10A		Blank: Standard Type
380: 24-440VAC	16: 16A		M: MOV
	25: 25A		T: TVS

